

	<b>With Trip-activated Striker Pin</b>	<b>With Thermally-activated Striker Pin</b>
<b>Item Code</b>	S1A4010.08	S1T4010.08
<b>Description</b>	U <sub>n</sub> =24kV, I <sub>n</sub> =10A, D=442mm	
<b>Application</b>	Indoor & Outdoor	
<b>Standards</b>	IEC 60282-1, DIN 43625, VDE0670-4	

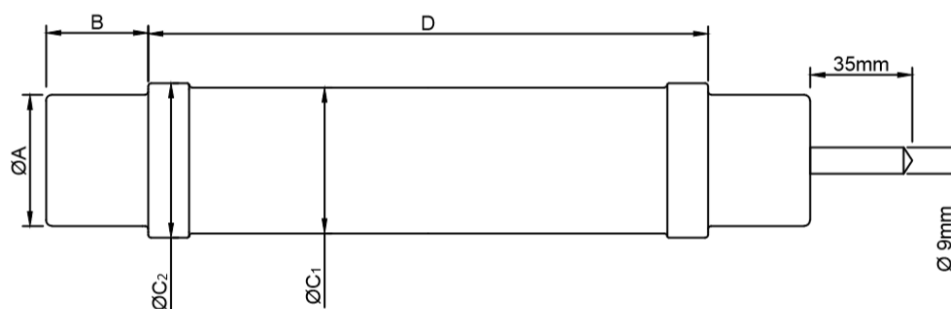

<b>MECHANICAL CHARACTERISTICS</b>						
<b>ØA (±1)</b>	<b>B (+2, -0)</b>	<b>D (+0, -1)</b>	<b>ØC<sub>1</sub> (±2)</b>	<b>ØC<sub>2</sub> (±2)</b>	<b>Striker Force*</b>	<b>Weight</b>
<b>mm</b>	<b>mm</b>	<b>mm</b>	<b>mm</b>	<b>mm</b>	<b>N</b>	<b>kg</b>
45	33	442	53	55	80	2,3

<b>ELECTRICAL CHARACTERISTICS</b>						
<b>Rated Voltage (U<sub>n</sub>)</b>	<b>Rated Current (I<sub>n</sub>)</b>	<b>Rated Breaking Current (I<sub>1</sub>)</b>	<b>Rated Frequency (f)</b>	<b>Minimum Breaking Current (I<sub>3</sub>)</b>	<b>Cold Resistance (R) (±10%)</b>	<b>Power Loss</b>
<b>kV</b>	<b>A</b>	<b>kA</b>	<b>Hz</b>	<b>A</b>	<b>mΩ</b>	<b>W</b>
24	10	63	50	50	223	27,5

\*Different striker pin types and forces are available upon request. Please refer to 2<sup>nd</sup> page for selection.

### Time – Current Curve

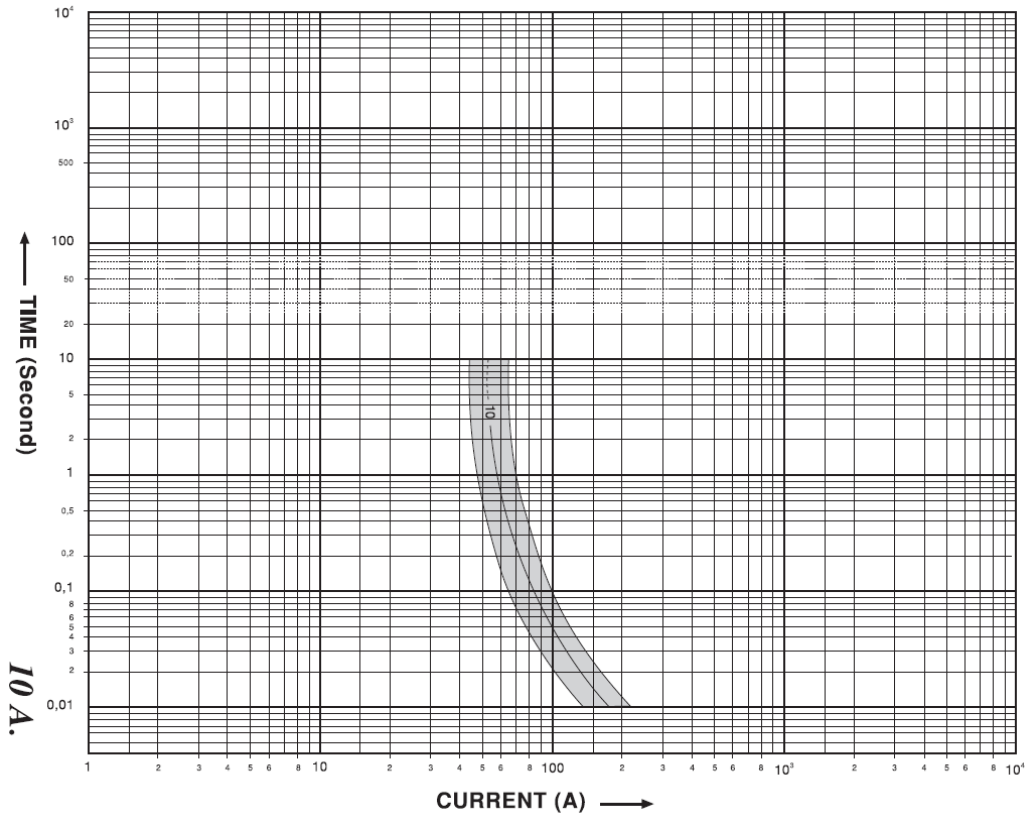

### Striker Pin Information

#### Travel – Force Diagram:

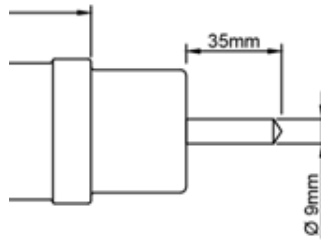
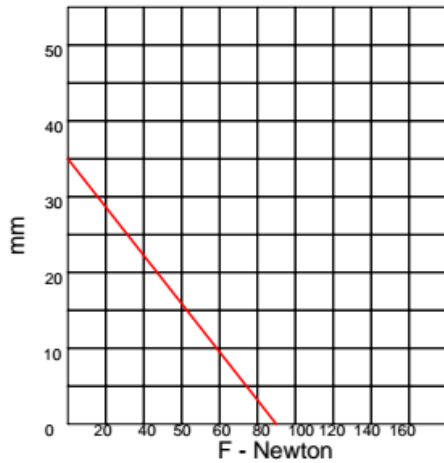

Striker Pin: 80N Force, medium class as per IEC 60282-1

#### Type and Force Selection:

S1□4010.□□

##### Striker Type:

- A: Operates when fuse breaks the current
- T: Thermally activated (F=80N only)
- O: Optical indication
- Z: Without striker

##### Striker Force:

- 05: F=50N
- 08: F=80N
- 12: F=120N
- Not used if Striker Type digit is "O" or "Z"