

| | With Trip-activated Striker Pin | With Thermally-activated Striker Pin |
|--------------------|--|---|
| Item Code | S4A4100.08 | S4T4100.08 |
| Description | $U_n=24\text{kV}$, $I_n=100\text{A}$, $D=442\text{mm}$ | |
| Application | Indoor & Outdoor | |
| Standards | IEC 60282-1, DIN 43625, VDE0670-4 | |

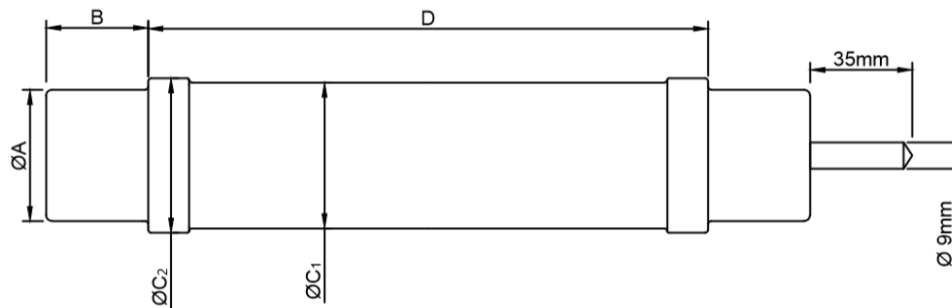

| MECHANICAL CHARACTERISTICS | | | | | | |
|-----------------------------------|---------------|---------------|----------------------------------|----------------------------------|-------------------|--------|
| $\varnothing A$ (± 1) | B (+2, -0) | D (+0, -1) | $\varnothing C_1$ (± 2) | $\varnothing C_2$ (± 2) | Striker Force* | Weight |
| mm | mm | mm | mm | mm | N | kg |
| 45 | 33 | 442 | 86 | 86 | 80 | 6 |

| ELECTRICAL CHARACTERISTICS | | | | | | |
|-----------------------------------|-------------------------------|---|---------------------------|---|---|---------------|
| Rated Voltage (U_n) | Rated Current (I_n) | Rated Breaking Current (I_1) | Rated Frequency (f) | Minimum Breaking Current (I_3) | Cold Resistance (R) ($\pm 10\%$) | Power Loss |
| kV | A | kA | Hz | A | m Ω | W |
| 24 | 100 | 63 | 50 | 483 | 11,8 | 210 |

*Different striker pin types and forces are available upon request. Please refer to 2nd page for selection.

Time – Current Curve

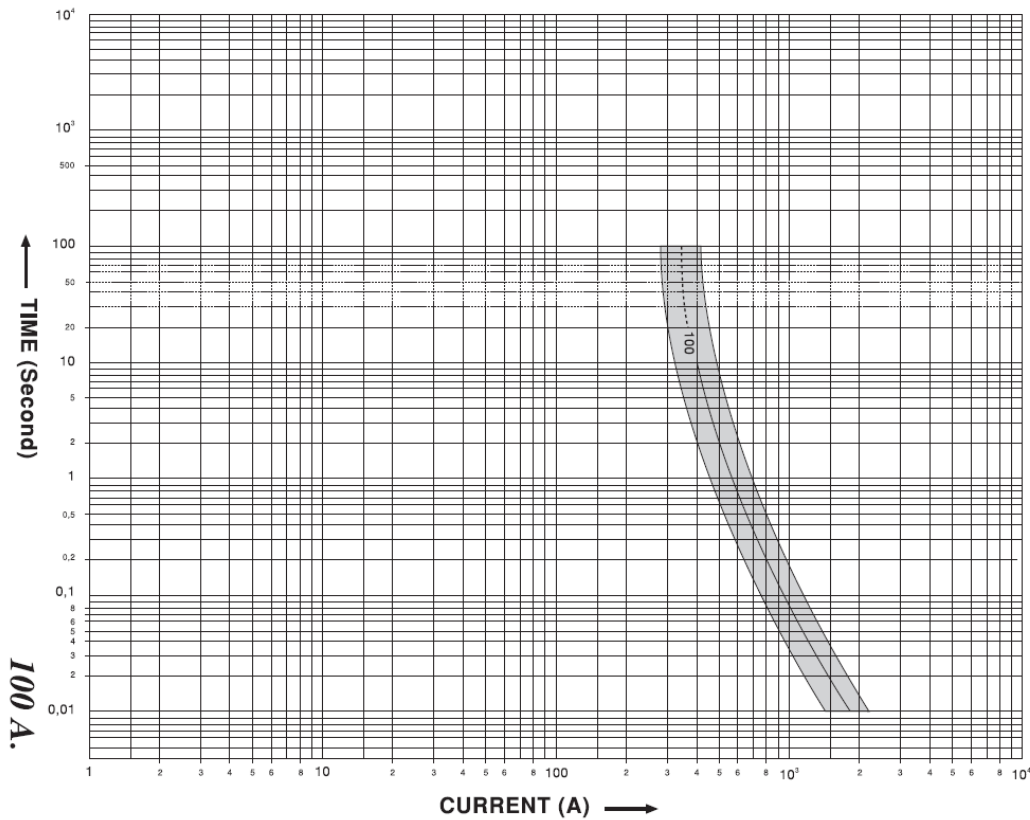

Striker Pin Information

Travel – Force Diagram:

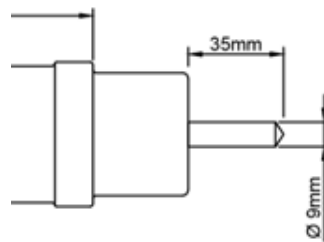
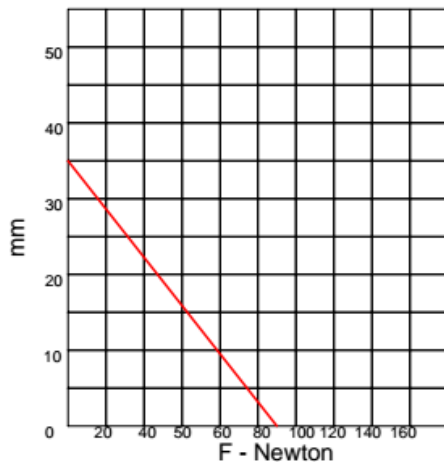

Striker Pin: 80N Force, medium class as per IEC 60282-1

Type and Force Selection:

S4□4100.□□

Striker Type:

- A: Operates when fuse breaks the current
- T: Thermally activated (F=80N only)
- O: Optical indication
- Z: Without striker

Striker Force:

- 05: F=50N
- 08: F=80N
- 12: F=120N
- Not used if Striker Type digit is "O" or "Z"